

## Speed Controls

# WV-M 1,25



**High feed force: 10.000 N**  
**Speed rates: 0,015 - 40 m/min**

Adjustment: Variable  
 Extended Life Time: Special Seals + Oils  
 Piston rod: hardened stainless steel  
 Housing: black finish

Integrated end stop  
 Temperature: -20°C - +80°C (-4°F - +176°F)  
 RoHS compliant: Directive 2002/95/EC

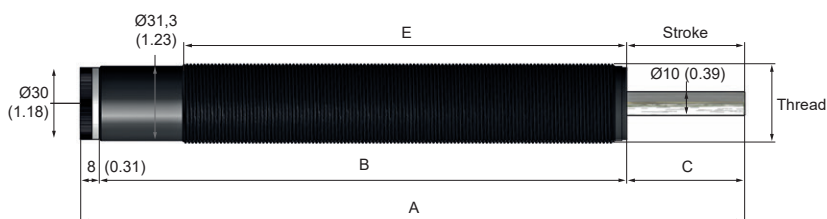

## DIMENSIONS

	Thread	A	B	C	D	E
		mm (inch)				
WV-M 1,25x1	M33x1,5	231 (9.09)	198 (7.8)	25 (0.98)	5 (0.2)	163 (6.42)
WV-M 1,25x2	M33x1,5	281 (11.06)	223 (8.78)	50 (1.97)	5 (0.2)	188 (7.4)
WV-M 1,25x3	M33x1,5	331 (13.03)	248 (9.76)	75 (2.95)	5 (0.2)	213 (8.39)

## PERFORMANCE

	Stroke mm (inch)	Speed force		Speed rates m / min (inch / min)				Return spring force		Weight kg (lbs)
		min. N (min. lbs)	max. N (max. lbs)	min. -1	max. -1	min. -2	max. -2	min. N (min. lbs)	max. N (max. lbs)	
WV-M 1,25x1	25 (0.98)	100 (22.48)	10000 (2248.09)	12 (472.44)	40 (1574.8)	0,015 (0.59)	15 (590.55)	35 (7.87)	100 (22.48)	0,95 (2.09)
WV-M 1,25x2	50 (1.97)	100 (22.48)	10000 (2248.09)	12 (472.44)	40 (1574.8)	0,015 (0.59)	15 (590.55)	35 (7.87)	100 (22.48)	1,05 (2.31)
WV-M 1,25x3	75 (2.95)	100 (22.48)	10000 (2248.09)	12 (472.44)	40 (1574.8)	0,015 (0.59)	15 (590.55)	35 (7.87)	100 (22.48)	1,15 (2.54)

## ACCESSOIRES

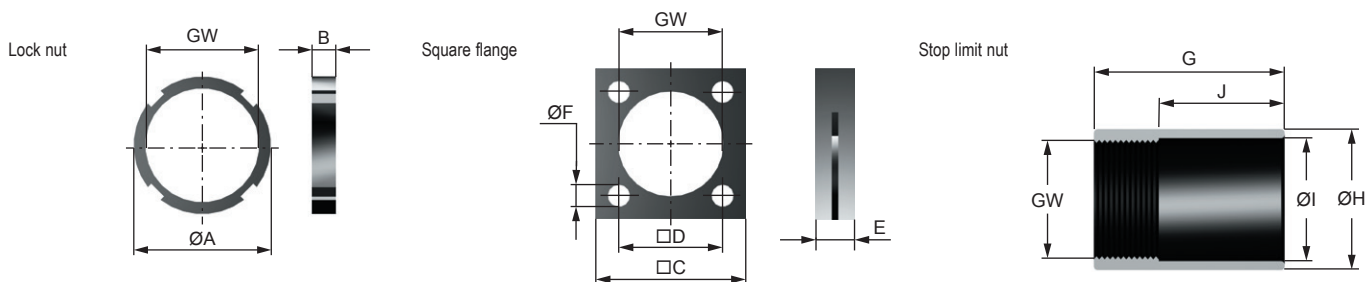

Code: S23012H

Code: S23014H

Code: S23018H

GW	Ø A (mm)	B (mm)	C (mm)	D (mm)	E (mm)	Ø F (mm)	G (mm)	Ø H (mm)	Ø I (mm)	J (mm)
M 33 x 1,5	38 (1.5)	6,5 (0.26)	45 (1.77)	32 (1.26)	12 (0.47)	6,6 (0.26)	60 (2.36)	38 (1.5)	33 (1.3)	35 (1.38)